

## DuraStyle Toilet seat and cover # 0060510000

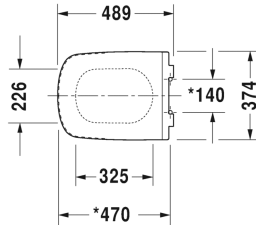

Toilet seat and cover	Dimension	Weight	Order number
removable, elongated, hinges stainless steel, without slow close			
<b>Colors</b>			
00 White			
<b>Variant</b>			
		5.7 lb	0060510000
<b>Suitable products</b>			
One-Piece toilet syphonic, 12" rough-in, vertical outlet, cUPC® listed*, 14 5/8" x 28 3/8" Inch	14 5/8" x 28 3/8" Inch		215701
Toilet wall-mounted washdown model, Durafix included, cUPC® listed*, 14 5/8" X 24 3/8" Inch	14 5/8" X 24 3/8" Inch		253709
Toilet close-coupled (without tank), washdown model, outlet for vario connector set, for horizontal and vertical outlet, length adjustable from 2 3/4" - 6 3/4", and vario connecting bend, vertical outlet from 6 3/4" - 8 5/8", hardware included, cUPC® listed*, 14 5/8" x 27 1/2" Inch	14 5/8" x 27 1/2" Inch		215609
Two-Piece toilet (without tank), syphonic, 12" rough-in, vertical outlet, cUPC® listed*, 14 1/8" x 27 1/2" Inch	14 1/8" x 27 1/2" Inch		216001
Toilet wall-mounted Duravit Rimless® rimless, washdown model, Durafix included, cUPC® listed*, 14 5/8" X 24 3/8" Inch	14 5/8" X 24 3/8" Inch		254209

All drawings contain the necessary measurements which are subject to standard tolerances. They are stated in inch & mm and are non-binding. Exact measurements, in particular for customized installation scenarios, can only be taken from the finished ceramic piece.