

ME by Starck Two-piece toilet for SensoWash® # 217151..00 / 217151..85

|< 14 1/8" Inch >|

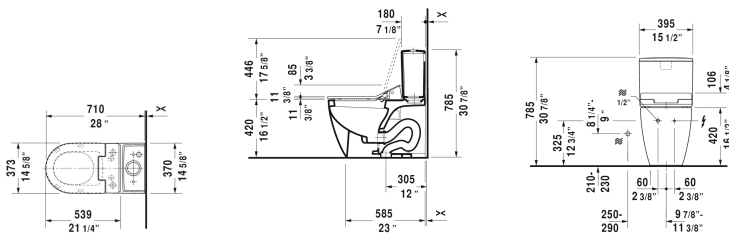

| Two-piece toilet for SensoWash® | Dimension | Weight | Order number |
|--|------------------------|----------|--------------|
| (without tank), syphonic, 12" rough-in, vertical outlet, only in combination with SensoWash, connecting elements for SensoWash with concealed connections included, cUPC listed | | | |
| Colors | | | |
| 00 White 20 HygieneGlaze (an antibacterial ceramic glaze that provides almost indefinite effectiveness) | | | |
| Variant | | | |
| ◆ 1.32/0.92 gpf | 14 1/8" x 28" Inch | 101.4 lb | 217151..00 |
| ◆ 1.28 gpf | 14 1/8" x 28" Inch | 101.4 lb | 217151..85 |
| Suitable products | | | |
| Mounting set for One-Piece and Two-Piece toilets, outlet 3/8" - male thread, wall connection 1/2" - female thread, 1/2", North American version | 17 3/4" Inch | 1.1 lb | 001417 |
| Tank for bottom left supply, 15 3/8" x 7 1/8" Inch | 15 3/8" x 7 1/8" Inch | | 093820 |
| SensoWash Slim shower-toilet seat for ME by Starck, Starck 2, Starck 3 and Darling New* with concealed connections, remote control included, locking function via remote control, rear-, front and oscillating wash, self-cleaning wand, with slow close, night light, seat and lid easily removable with one hand, automatic drainage in periods of prolonged disuse, on / off-button, 14 3/4" x 21 1/4" Inch | 14 3/4" x 21 1/4" Inch | | 611000 |

All drawings contain the necessary measurements which are subject to standard tolerances. They are stated in inch & mm and are non-binding. Exact measurements, in particular for customized installation scenarios, can only be taken from the finished ceramic piece.