

Link

Design by Ramón Esteve



ASSEMBLY INSTRUCTIONS





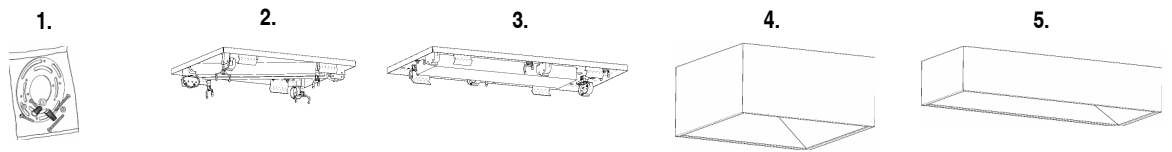



CAUTION: TO AVOID POSSIBLE ELECTRICAL SHOCK, MAKE CERTAIN ELECTRICITY IS SHUT OFF AT MAIN PANEL BEFORE WIRING
 All wiring must be in accordance with national and local electrical codes. If you are not familiar with wiring, you should use a qualified electrician.
 This product must be installed in accordance with the applicable installation code by a person familiar with the construction and operation of the product and the hazards involved.

SUPPLIED MATERIAL



	5373	5379
1 Components bag	1 un.	1 un.
2 Plaque 37,8 x 37,8 cm.	-	1 un.
3 Plaque 22,8 x 57,8 cm.	1 un.	-
4 Module 40 x 40 cm.	-	1 un.
5 Module 25 x 60 cm.	1 un.	-

TECHNICAL SPECIFICATIONS

5373.	Net Weight	11.46 lbs.		2 x PL-L 2G11 24W 2 x PL-L 2G11 18W			~ 50-60 Hz	
5379.	Net Weight	13.23 lbs.		4 x PL-L 2G11 24W			~ 50-60 Hz	

 Product protected against solid object as big as or bigger than 12 mm.
 No protection against water.
 ~ Alternating current

Caution

Before assembling and installing this product, carefully read the following:

- Switch off the mains before installing the lamp.
- Always use the recommended bulb
- To install on the ceiling, always choose the most adequate fixing tools for the ceiling material.
- This lamp is for indoor use only, excluding bathrooms or any type of humid surface.
- Make sure your ceiling can support the weight of the lamp.
- We recommend reading the manual before installing the lamp. Keep these instructions for future reference since they contain Information on bulb replacing and maintenance.

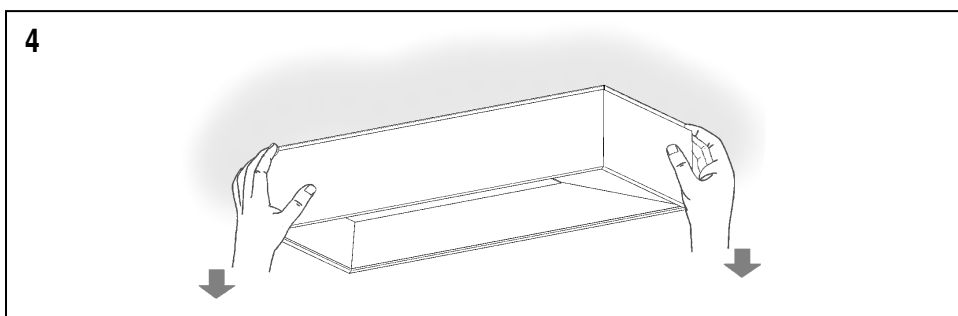
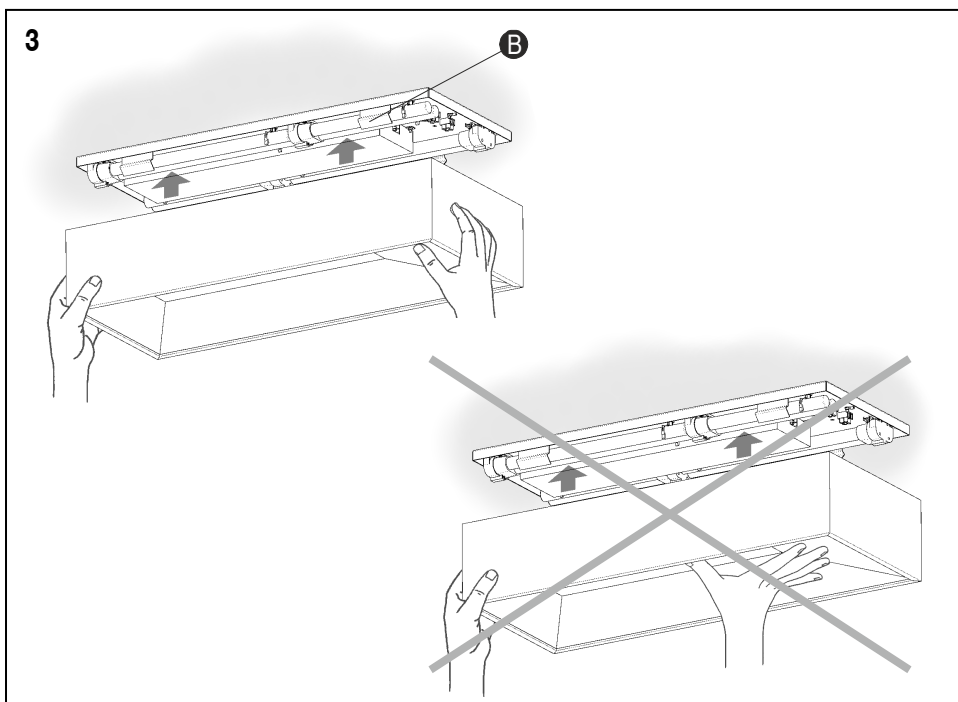
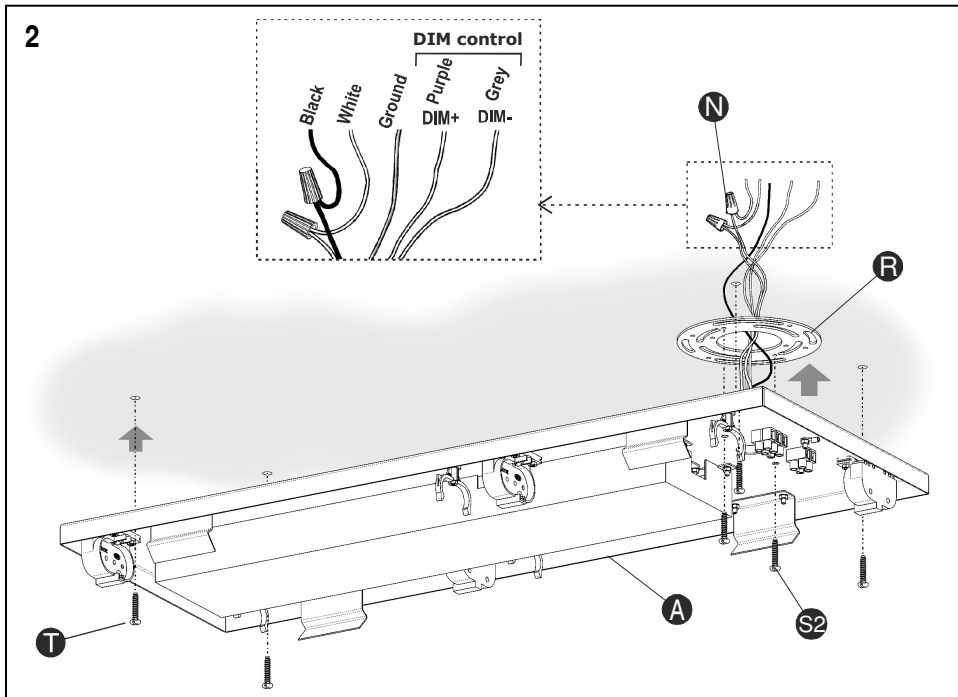
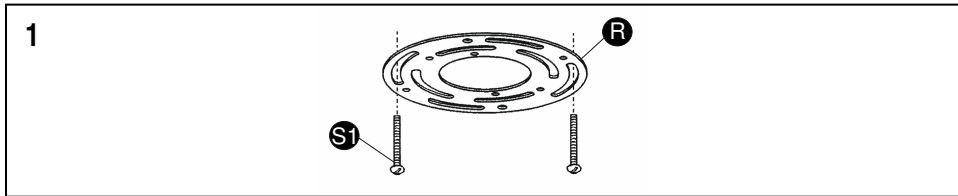

IMPORTANT NOTICE:

Caution: to avoid possible electrical shock, make certain electricity is shut off at main panel before wiring.

1. Making certain that the threads of the cross bar screws are pointing away from the wall, secure the round cross bar (R) to the junction box using the mounting screws (S1).

2. Connect the white fixture wire to the white wire of the supply circuit. Connect the black fixture wire to the black wire of the supply circuit. Secure with the wire nuts (N) and tape connections with electrical tape. Connect the fixture yellow and green ground wire and the supply green tinted ground wire to the ground screw on the round cross bar using the ground terminal.

Connect your DIM control lines to poles DIM+ (Purple) and DIM- (Grey).

NOTE: If system is not compatible with 5 wire 1-10V dimming or if you wish to install this fixture as non dimmable, you may cap off the dim+ and dim- wires.

Push the connections and all excess wire to the interior of the junction box. Spread the electrical splices on the round cross bar (R) so that the black wires are on one side of the junction box and the white wires on the other. Secure the plaque (A) to the round cross bar, using the cross bar screws (S2), and 4 extra screws (T) (not supplied).

3. After installed the bulbs, attach the module to the tray and push it upwards, making sure the module is properly secured with the strips (B), until it clicks into place.

PRECAUTION: Do not press on the diffuser when fitting the module.

FOR MAINTENANCE OR RELAMPING OF BULBS

4. Pull the module as shown in the drawing to release it from the tray. Do not let go of the module at any time from releasing the strips to putting it down in a safe place. Afterwards, replace it as described in the previous step.

Maintenance

- Use a slightly-wet cotton cloth for cleaning.
- In case of malfunction or damage, please contact the retailer who sold the lamp.