

SUPPLIED MATERIAL





1.

2.

3.

4.

5.



0700.

0710.

Only for references

0700-04-INC

0710-04-INC

	0700-INC	0710-INC
1 Globes	1 un.	1 un.
2 Allen key	1 un.	1 un.
3 Shade	1 un.	1 un.
4 Reflector	1 un.	1 un.
5 Lighting fixture	1 un.	1 un.

TECHNICAL SPECIFICATIONS

0700	Net Weight	7.54 lbs		1 x BA-9 120V 60W Max.	IP20		~ 50-60 Hz	DRY LOCATION	<div>IP20</div> <div>Product protected against solid object as big as or bigger than 1/16.</div> <div>No protection against water.</div> <div>~ Alternating current</div>
0710	Net Weight	25.57 lbs		1 x BA-9 120V 60W Max.	IP20		~ 50-60 Hz	DRY LOCATION	

VERY IMPORTANT

CAUTION: TO PREVENT ELECTRIC SHOCK, MATCH WIDE BLADE OF PLUG TO WIDE SLOT, FULLY INSERT.
ATTENTION: POUR ÉVITER UN CHOC ÉLECTRIQUE, PRÉSENTER LA LAME LARGE LA FENTE LARGE ET POUSSER JUSQU'AU FOND.
CAUTION: HOT SURFACE. KEEP AWAY FROM CURTAINS AND OTHER COMBUSTIBLE MATERIALS.
ATTENTION: SURFACE CHAUDE. TENIR L'ÉCART DES RIDEAUX FORME ET D'AUTRES MATÉRIAUX COMBUSTIBLES.
DRY LOCATIONS ONLY.
POUR EMPLACEMENTS SECS SEULEMENT.

Caution

Before assembling and installing this product, carefully read the following:

- Always use the recommended bulb
- If the steel cable or the power cord of this lamp is damaged, it must be replaced only by the manufacturer or their technical service or by a person capacitated to this effect to avoid any risk.
- This lamp is for indoor use only, excluding bathrooms or any type of humid surface.
- We recommend reading the manual before installing the lamp. Keep these instructions for future reference.
- Use these gloves to touch the lamp during the installation to avoid smudges and dirt on its surface.

ASSEMBLY INSTRUCTIONS

1

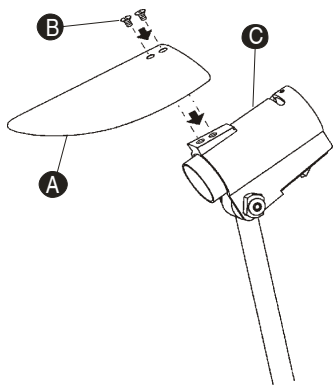

1. Install the reflector (A) using the two screws (B) that were removed from the body (C).

2. Install the shade (D) on the body (C) as shown by the arrow, so that the rib on the body slides completely into the slot on the shade (see X detail).

3. Tighten the inner peg (E) using the supplied Allen key. In this way the shade will be fixed in place.

2

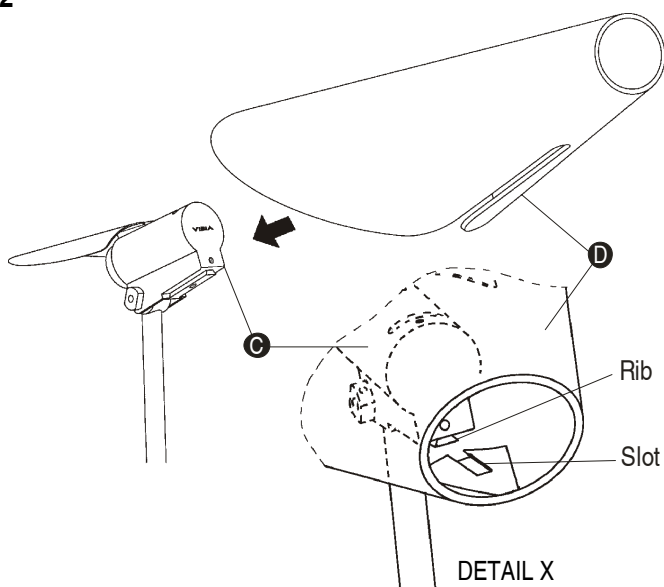

3

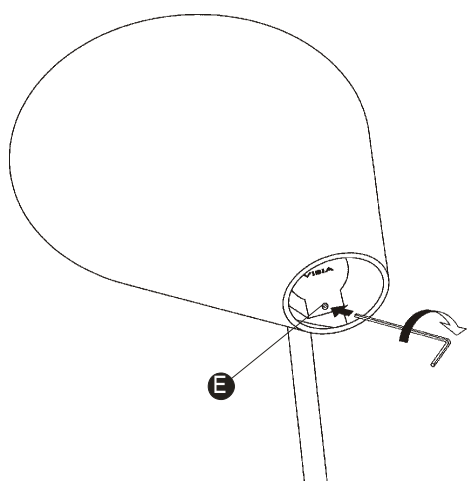

Maintenance

-Use a slightly-wet cotton cloth for cleaning.

-In case of malfunction or damage, please contact the retailer who sold the lamp.