

ATRIO

MODEL # 19888000

GROHE CANADA, INC. | 5900 Avebury Road, Mississauga, Ontario, Canada L5R 3M3
Phone: 905-271-2929 | Fax: 905-271-9494 | info@grohe.ca

Pure Freude
an Wasser

GROHE

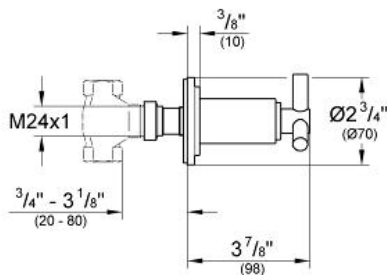

Product Description:
ATRIO

Standard Specification:

for concealed valves, 1/2", 3/4", 1"

- Adjustable installation depth
- Adjustable installation depth: 3/4" - 3 1/8" (20-80 mm)
- With Ypsilon handle
- **GROHE StarLight** chrome finish
- For use with Rough-In Valve (29 273) or (29 274)
- **GROHE SilkMove**

Applicable Codes & Standards:

- Energy Policy Act of 1992
- ASME A112.18.1/CSA B125.1

Color:

- 19888000 StarLight Chrome