

# Assembly & Installation Instructions

Celesse Pendant 138920

**A437**

Page 1 of 6

**CAUTION: FAILURE TO INSTALL THIS FIXTURE PROPERLY MAY RESULT IN SERIOUS PERSONAL INJURY OR DEATH AND PROPERTY DAMAGE. We recommend installation by a licensed electrician.**

This product must be installed in accordance with applicable installation code(s), by a person familiar with the construction and operation of the product and the hazards involved.\*

**Caution:** Do not exceed maximum wattage noted on fixture. Use only recommended bulbs with fixture.

## To Install Canopy

### Component Parts (Figure 1)

- A Canopy
- B Canopy Cover Plate
- C Cap
- D Transformer Plate
- E Anchors
- F #10 Screws
- G
- H #8 Screw

(Figure 1)

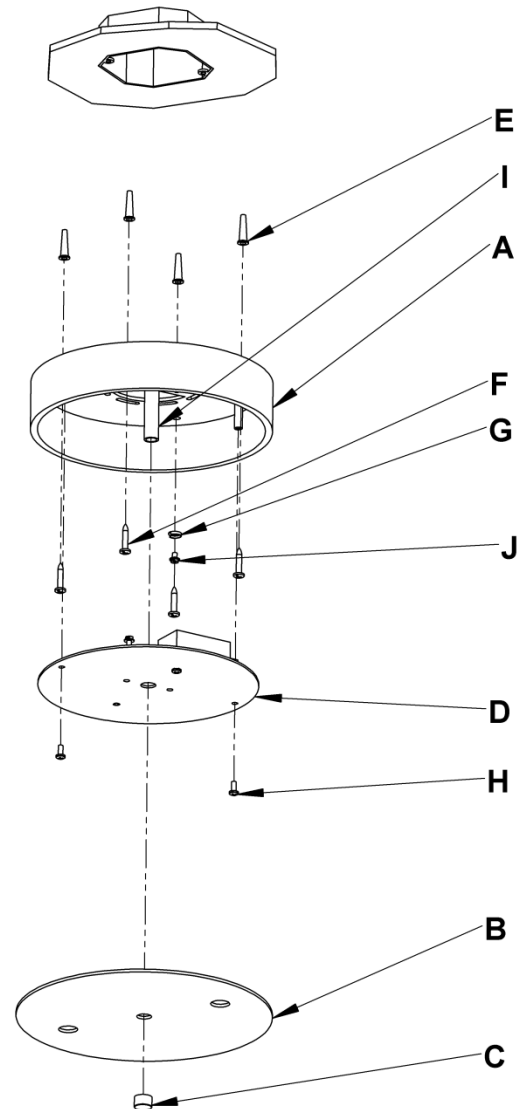

**Caution:** Be sure power is off at the main breaker box prior to installation. This installation requires 2 people.

**NOTE:** A 1/2" socket tool is required to assemble this fixture.

1. Carefully unpack the fixture from the carton.
2. Do not remove zip ties and foam sheets that are holding the rings secure at this time.
3. Locate canopy assembly. Remove cap (C) and canopy cover plate (B) and set aside for use later.
4. Remove 2 #8 screws (H) and lift transformer plate (D) out of canopy, set aside for use later.

**IMPORTANT:** This fixture may either be mounted directly to the junction box or be mounted using anchors and screws. To mount fixture using anchors see step 5. To mount directly to junction box see step 6.

5. **To attach canopy to ceiling using anchors:** Place the canopy (A) over the electrical box. With a pencil, mark the location of all mounting holes on the ceiling. Drill 1/4" holes in the locations marked on the ceiling. Place the tapered end of the anchors (E) into the holes and gently tap them flush to the ceiling using a light weight hammer.

Thread the wires in the electrical box through the hole in the canopy (A) while moving the canopy into position.

Using the 1" #10 screws (F), screw the canopy (A) securely to the ceiling. Be careful not to over-tighten or strip the anchors (E). Proceed to step 7.

6. **To attach canopy directly to the junction box:** Thread the wires in the electrical box through the hole in the canopy (A) while moving the canopy into position. Using two machine screws (not provided) fasten canopy (A) to the electric box.

**Note:** A new electric box comes with screws. When replacing a fixture, retain the existing screws for use with the new fixture.

(continued)

# Assembly & Installation Instructions

**A437**

Celesse Pendant 138920

Page 2 of 6

## To Assemble Fixture (Figures 2 & 3)

### Component Parts

- A Canopy
- C Cap
- D Transformer Plate
- G Cupped Washer
- J Ground Screw
- P Ball Cap
- Q Tall Hex Coupling
- R Washer
- S Lockwasher
- T Plastic Grey Washer

(Figure 2)

7. While holding the transformer plate (D) close to the canopy, using suitable wire connectors (not provided) connect transformer wires to supply wires (white to white and black to black). Connect pigtail lead from the ground screw (J) and cupped washer (C). Connect all ground wires (bare copper or green to bare copper or green) together.

**Caution:** Make sure wire connectors are twisted on securely, and no bare wires are exposed

8. Locate the two halves of the fixture. One half has the center connecting bar attached to it and the other doesn't. (Figure 2). Remove the cap (P) using the grey plastic washer (T) from the half of the fixture that does not have the bar.

9. Slide the center connecting bar from one half into the ball of the other half. (Two people are needed for this step). Choose one of the possible orientations and seat the hex feature of the bar into the ball. To determine the orientation that achieves the aesthetic result that you desire please see pages 4-6.

10. Slip the lockwasher (S) and washer (R) onto bar. **Helpful Hint: To aid in putting the washers on the bar. Load the tall hex coupling (hex portion facing out), washer and then the lockwasher onto a screwdriver (see picture A). Place the tip of the screwdriver on the end of the bar and let the washers slide down the screwdriver over the end of the bar.** With your hand thread the tall hex coupling (Q) onto bar a couple of turns.

**CAUTION: Be very careful to not pinch the wires under the hex coupling.** Using ½" socket tool (not provided), tighten the tall hex coupling down.

11. Thread the cap (P) back into the ball using the grey plastic washer (T).

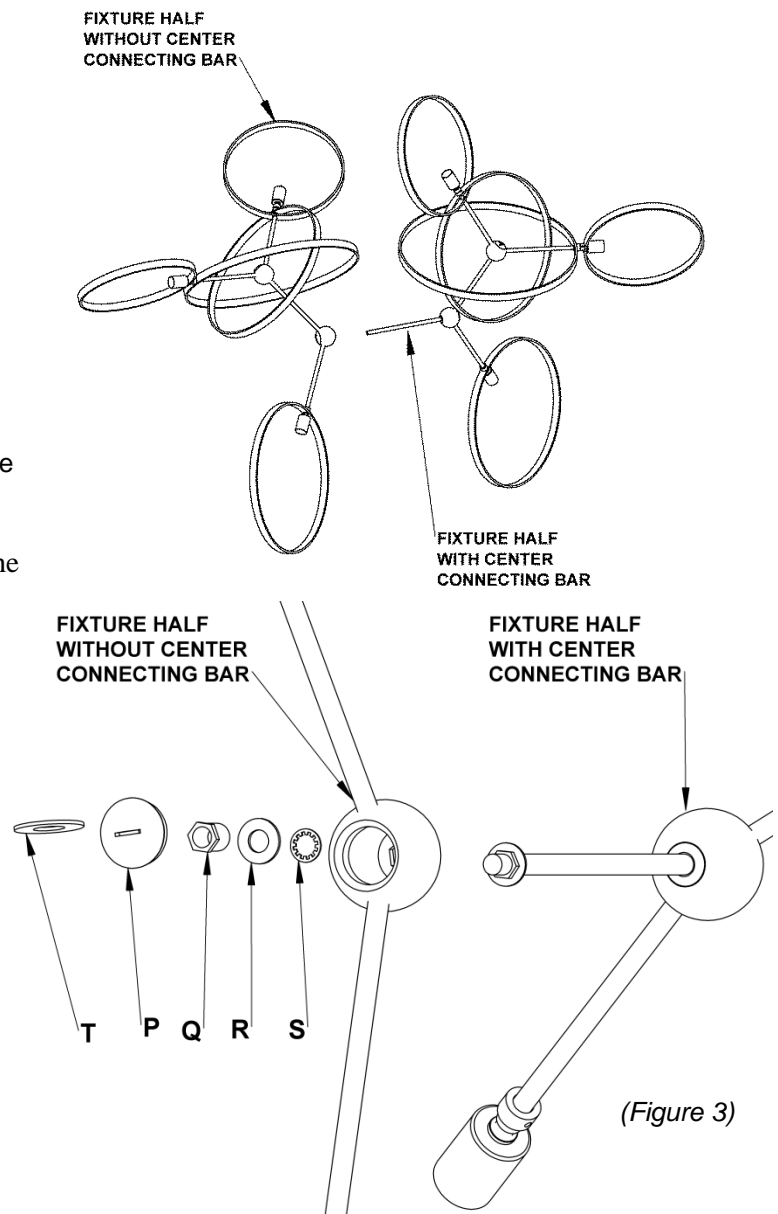

(Figure 3)



(Picture A)

**To Complete wiring of the fixture** (Figures 4 & 5)

**Component Parts**

- A Canopy
- B Canopy Cover Plate
- C Cap
- I Nipple
- K Knurled Gripper nut
- L Gripper
- M Male Disconnect
- N Hex Gripper Nut
- O Female Disconnect
- U Bulb (not included)
- V Glass

12. For one half of the fixture, locate end of cable.
13. Route female disconnect (M) through one of the outer holes in canopy cover plate (B) and gripper hex nut (N).
14. Slip gripper (L) in canopy cover plate (B) and secure using knurled gripper nut (K) and hex gripper nut (N). Make sure the side of the canopy cover (B) that has the support cable is facing up. Repeat for second half of fixture. (NOTE: Be sure to check routing of cable thru rings to prevent interference. If needed, it is possible to disconnect and re-route cable after fixture is hung and rings adjusted.)

15. Determine approximate height that the fixture is to be hung at and adjust cables as necessary.
16. Remove screw from transformer plate, retain screw for use in next step.

17. Raise canopy cover plate (N) and fixture up close to the ceiling. Attach the support cable from the canopy cover plate (B) with the screw.
18. Plug female disconnect (O) into male disconnect (M).
19. Repeat for second set of disconnects.
20. Slide canopy cover plate (B) over nipple (I) and secure in place with cap (C). Carefully tuck cables into canopy ensuring that not cables or wires are pinched between the canopy cover plate(B) and the canopy (A).
21. Fine tune fixture desired hanging height using the grippers.
22. Install bulbs (U) (not supplied) and glass (V).
23. Remove zip-ties and foam sheets. Loosen set screws (with provided hex wrench) that are holding rings in place. Move and rotate rings to desired position and retighten set screws. See pictures on pages 4-6 for suggested ring locations.
24. Restore electricity at main breaker

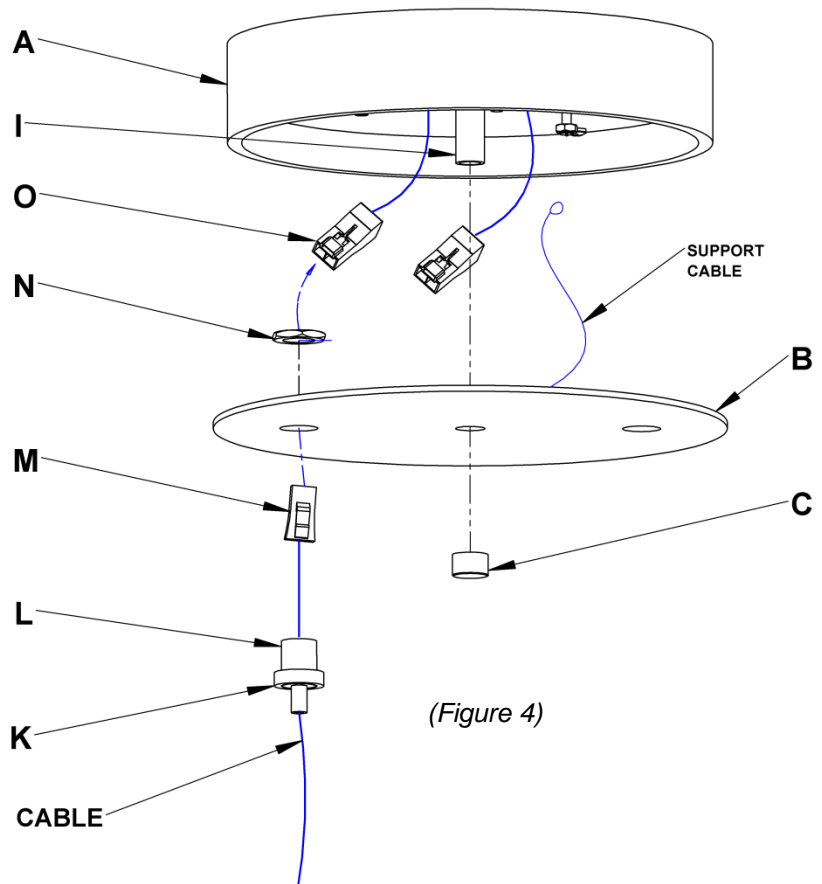

(Figure 4)

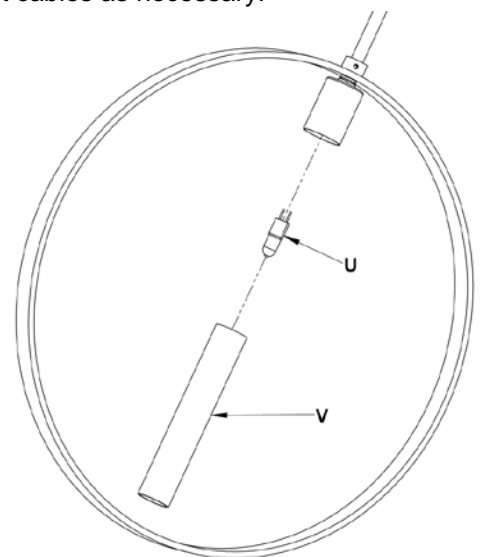

(Figure 5)

## Orientation A

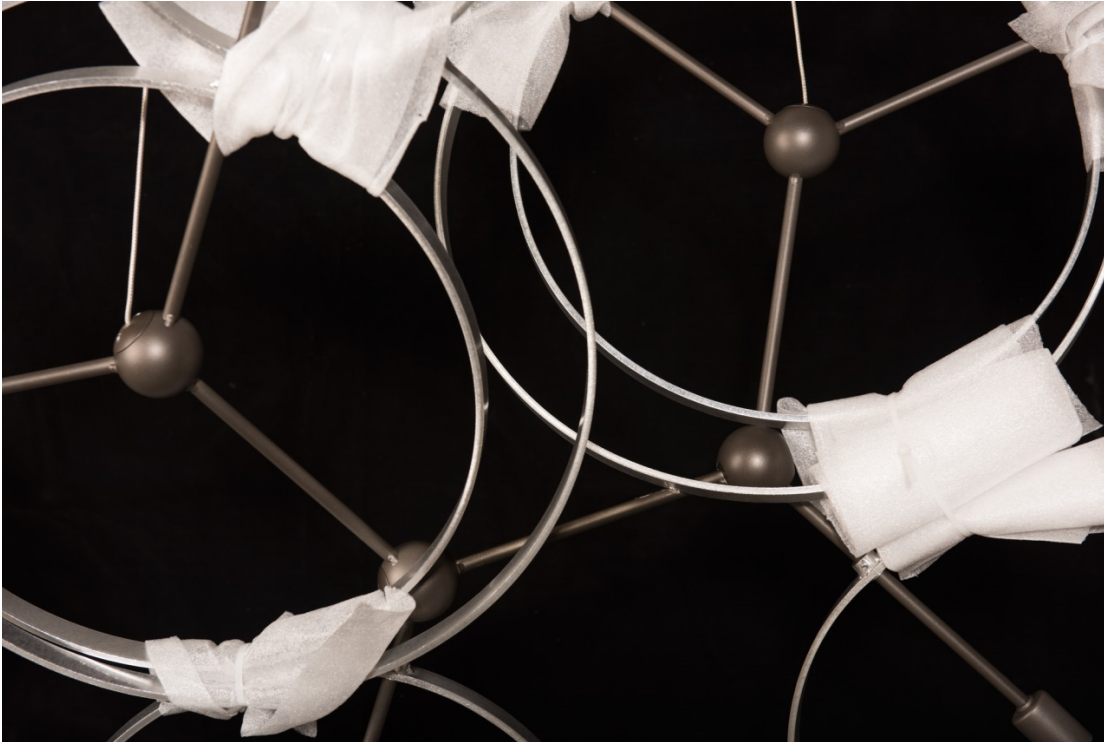

*Photo of core of fixture for orientation A*

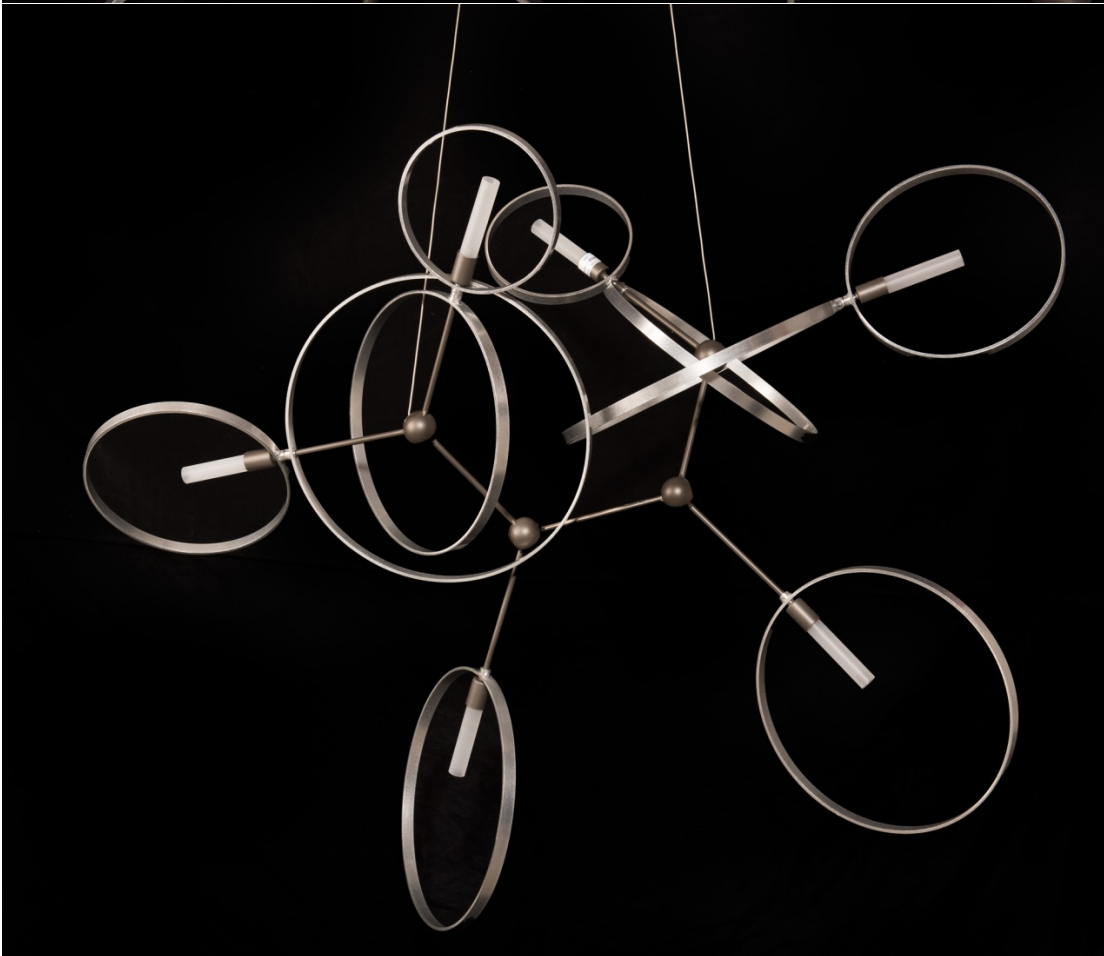

*Completed installation orientation A*

# Assembly & Installation Instructions

Celesse Pendant 138920

**A437**

Page 5 of 6

## Orientation B

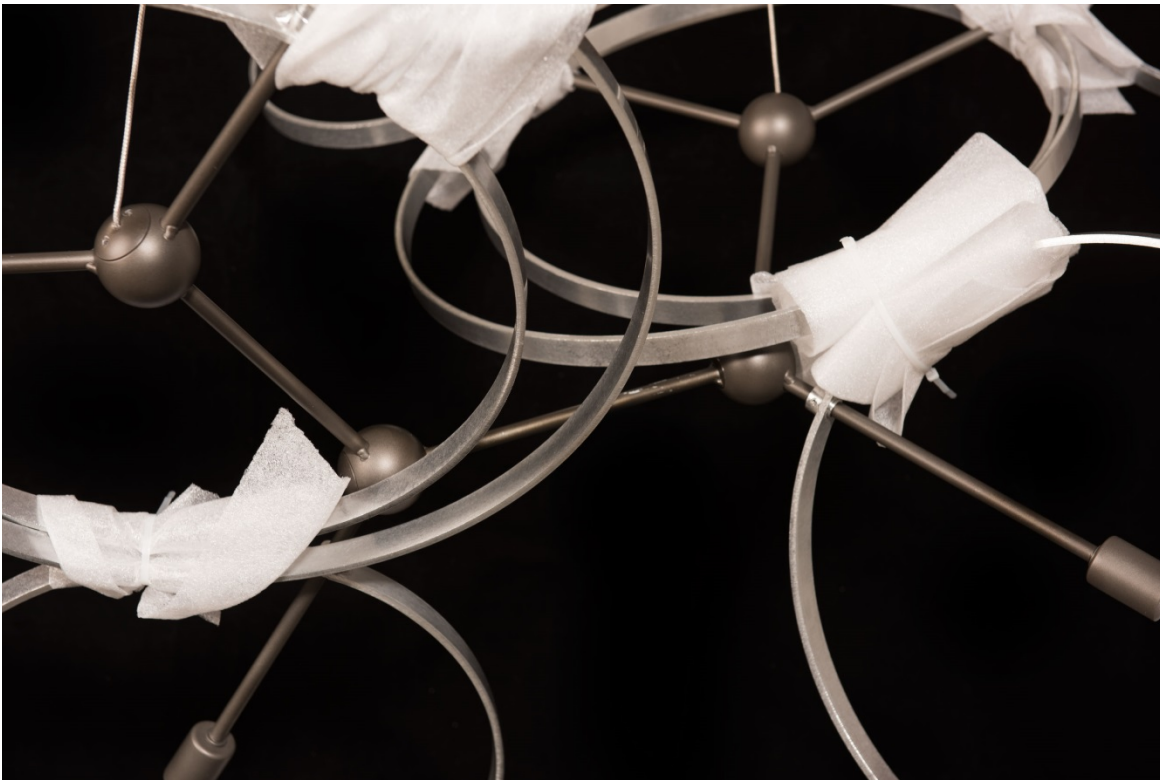
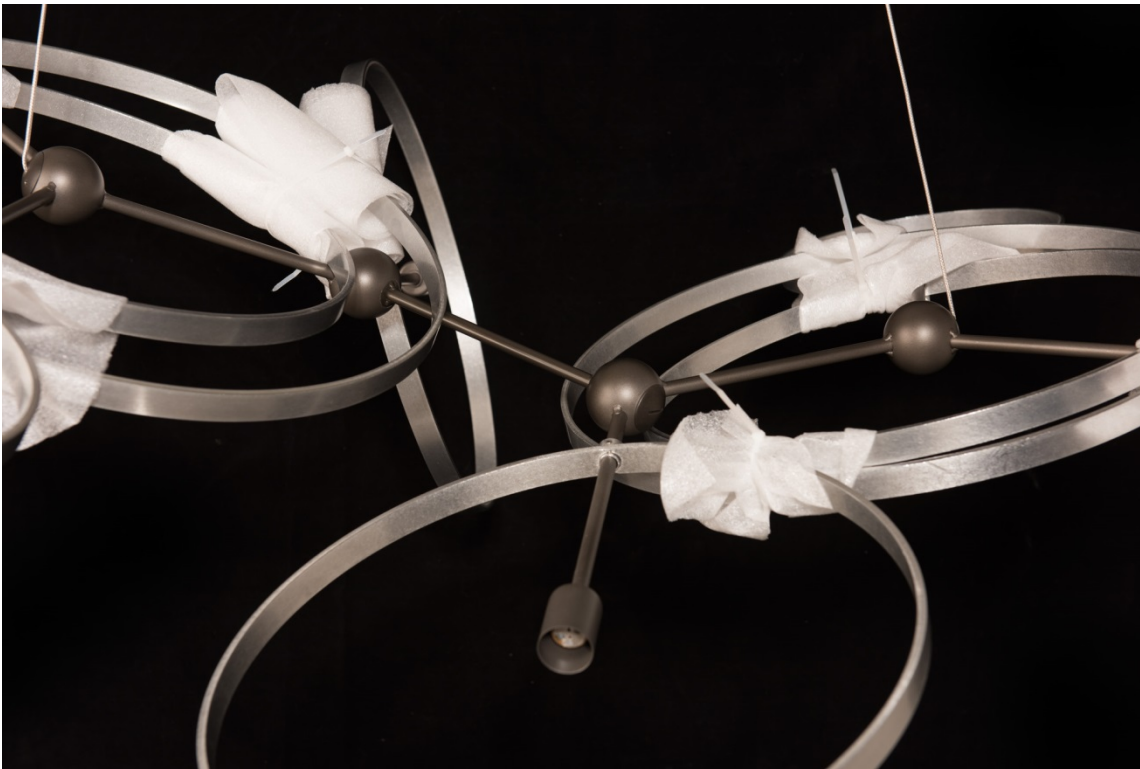

*Photo of core of fixture for orientation B*



*Completed installation orientation B*

## Orientation C



*Photo of core of fixture for orientation C*



*Completed installation orientation C*

*If you need further assistance, or find that you are missing any parts, please contact the dealer from which you purchased this product. We hope you enjoy your fixture!*

\* Hubbardton Forge will not be liable for injury or damage caused by improper installation, lamping or use of this fixture.