

Exhibit 6032 IFS AFR

Model number:

105512

Dimensions: 60" x 32" x 20"

Installation: Alcove

Material: Acrylic



Standard Features:

- Rectangular shape bathtub in alcove installation
- Available in Above-the-Floor Rough (AFR) or not
- Minimalist look with discreet armrests and textured floor
- Deck for faucet installation
- Integrated skirt with access panel when equipped with a system

Product characteristics:

- Elegant design
- Integrated Tiling Flange and Skirt
- Textured Floor

Systems:

 Whirlpool

 Combined Whirlpool/Aeroeffect

 Aeroeffect

Warranty:

25 Years

Standard colors:



White (001)



Bone (004)



Biscuit (007)

Certifications

MAAX products adhere to one or more of the following certifications:



Recommended products (Visit our website for a complete list of our recommended doors)

No	Description
139398	Halo Sliding Tub Door 56 ½-59 x 59 in. 8 mm
105409	Mika Sliding Tub Door 54 - 59 ½ x 55 in.
134661	Kameleon SC Sliding Tub Door 55-59 x 57 in. 6 mm

Options (Visit our website for a complete list of our options)

No	Description
<input type="checkbox"/> OPT 10019	Removable access panel
<input type="checkbox"/> OPT 10053	Chromatherapy
<input type="checkbox"/> OPT 10095	Water heater assembly
<input type="checkbox"/> OPT 10106	Metal trim kit for whirlpool and combined systems
<input type="checkbox"/> OPT 20029	Metal trim kit for Air Push Control

Exhibit 6032 IFS AFR

Model number:	105512
---------------	--------

Dimensions:	60" x 32" x 20"	Installation:	Alcove	Material:	Acrylic
-------------	-----------------	---------------	--------	-----------	---------

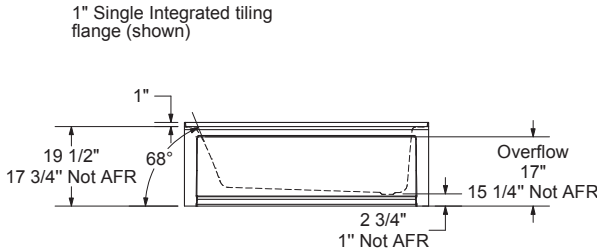
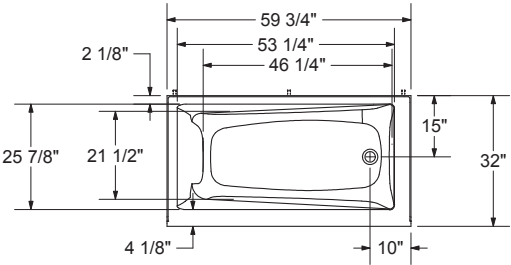

Wood support design may vary.
Single Integrated tiling flange: 1" height x 1/4" thickness (shown)

All dimensions are approximate.
Structure measurement must be verified against the unit to ensure proper fit.

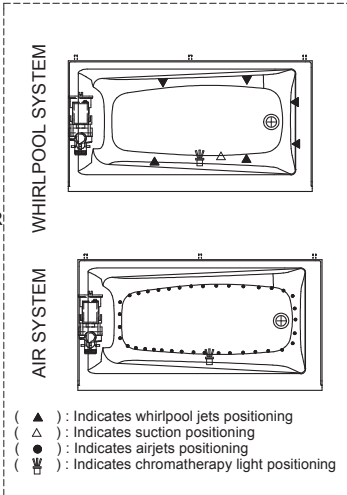
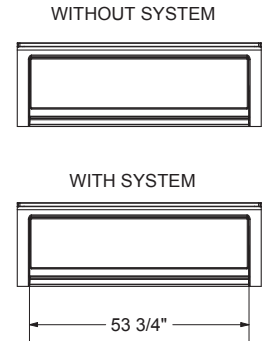

Dimensions:
59 3/4 x 32 x 19 1/2 in. (1518 x 813 x 495 mm)
Water capacity:
46 gallons - 173 liters
Weight:
78 lbs - 35.37 kg
Bathing well:
53 1/4 X 25 7/8 in. (1353 X 657 mm)
Deep sump height:
16 1/4 in. - 413 mm
Deck width:
4 1/8 in. - 105 mm
Drain location:
Left
Right

Project:	
Contractor:	
Representative:	
Date:	
Tel:	
Notes:	