

4" Round Swivel Canopy

700DJ4RS_

1.7



DISPLAY JACK

GENERAL PRODUCT INFORMATION:



This product is suitable for indoor dry locations only.

This product can mount to a 4" square electrical box with round plaster ring or an octagon electrical box. The minimum volume of the box must be 6 cubic inches (96 cubic centimeter).

This product can be dimmed with a standard incandescent dimmer.



CAUTION — RISK OF FIRE

This product requires installation by a qualified electrician. Before installing be sure to read all instructions and **TURN THE POWER TO THE ELECTRICAL BOX OFF.**

Mount the 4" Round Canopy to the Electrical Box

1A

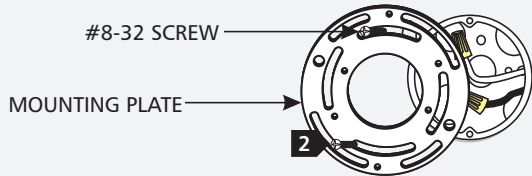

- 1 Line up two mounting plate slots with the two electrical box holes.
- 2 Secure the mounting plate to the electrical box with the two short #8-32 screws provided.

1B

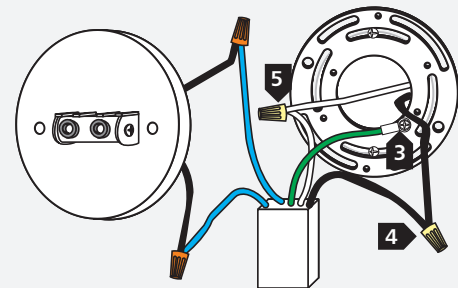

- 3 Connect the green ground wire according to electrical code of the region.
- 4 Connect the black transformer wire to the hot power line wire with a wire nut.
- 5 Connect the white transformer wire to the neutral power line wire with a wire nut.

1C

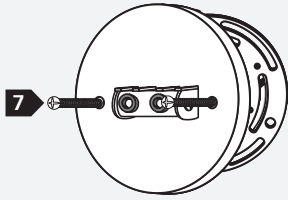

- 6 Place the transformer and all wires properly inside the electrical box.
- 7 Mount the 4" round canopy to the electrical box with two long #8-32 screws provided.

1D

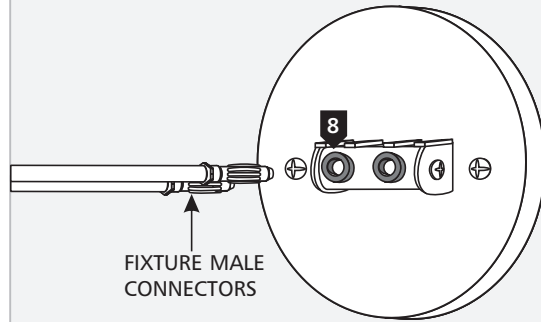

- 8 Push the two fixture male connectors all the way into the Display Jack ports.

SAVE THESE INSTRUCTIONS!



TECH LIGHTING®

7400 Linder Ave, Skokie, IL 60077

847.410.4400

www.techlighting.com

© 2008 Tech Lighting, L.L.C. All rights reserved. The "Tech Lighting" graphic is a registered trademark of Tech Lighting, L.L.C. Tech Lighting reserves the right to change specifications for product improvements without notification.

A Generation Brands Company